

Concrete Industry Sub-Assemblies

For Water Measurement, Batch Control and Dispensing Systems



Badger Meter, Inc.
Concrete Products

Badger® Engineered Sub-Assemblies for Chemical Admixture Systems

NEW! Dispenser Manifold Assembly

Put an End to Jury-Rigged Compromises. Badger's Innovative Manifold Lets You Configure it Your Way to Optimize Your Dispensing Application.

Manifold body is a single rugged casting for longer, more reliable performance life.

This exciting new dispenser manifold assembly gives you the flexibility and money-saving features you've been looking for — plus all these Badger advantages:

• 1" NPT connection delivers twice the flow capacity of $\frac{3}{4}$ " manifolds.

• Space-saving side-by-side cylinders. More compact design means you can put more dispensers in line!

• New poppet design for positive retention of disk. Disk available in a choice of materials.

Manifold Meets ASME/ANSI B16.15, Class 125 standards.

• New air cylinder design. Improves manifold-to-cylinder seal and stem sealing. Interchangeable shaft seals available in O-Ring or Cup Seal design in a variety of materials properly suited to your application — reducing premature corrosion, maintenance and replacement.

NEW! Now Available in ASME Stainless Steel

ASME Stainless Steel Measuring Unit

Badger is all about quality — and choice. Now, you can choose either a non-ASME rated measuring unit or our new ASME stainless steel model for applications where very high corrosion resistance is a must. Rated to 100 psig, it is available in sizes from 120 oz. to 30 gal. and is equipped with zero and overfill probes. Includes safety relief valve and drain assembly designed for easy calibration and standardized mounting brackets for quick change-out. Available plain, or painted in your choice of red or white.

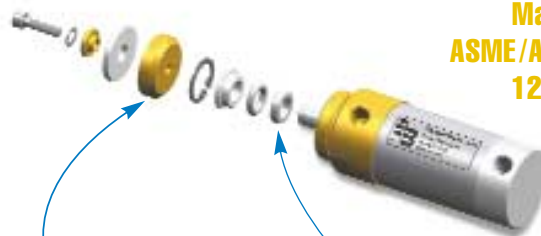
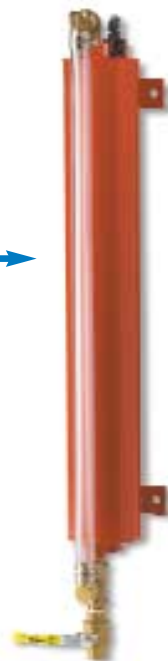

Assured Badger® Quality, Performance and Selection – Why Go Anywhere Else?

Factory Tested, Field Proven Accuracy — Ready to Install in Your System

Badger offers you a complete line of dispenser unit sub-assemblies for virtually every admix application. You'll appreciate our extensive inventory of components in a wide selection of sizes, materials and pressure ranges — all ready to configure for your system requirements and then ship to you without delay. Our team of experienced technicians will be happy to discuss your design requirements to assure that you get exactly what you need.



Acrylic Measuring Unit

This unit's transparent acrylic design lets you check your admixture at a glance. Reinforced with sturdy zinc-plated end plates and fully compatible with most admixtures. Equipped with zero and overflow probes, as well as a safety relief valve and a drain assembly design for easy calibration. Sizes from 30 oz. to 1900 oz. Includes standardized mounting brackets for quick change-out.



Electric Over Air Solenoid Valve Assembly/SMC Style

This field-tested workhorse delivers reliable performance in all environments. Choose either single or multiple product assembly options. Includes 1/4" 4-way manifold mount, fill regulator, nickel plated fittings and manual override. Designed by SMC for Badger Meter customer requirements.



Dual AGV Valve

Badger engineering takes a few more worries off your list. First, the valve's flow control system is designed with separate air and fluid chambers and a spring assist closure to prevent admixture seepage into airlines. Second, the air system requires no lubrication, so you don't need the added expense, space or maintenance required for an oil lubrication system. Finally, if you should ever experience a sudden loss of pressure, this unit remains closed automatically, preventing inadvertent admixture release.



Measuring Unit Pressure Head

Available in either aluminum or plastic composite styles, includes 1/4" air port and a 3/8" exhaust port. Nickel plated air fitting is minimum 1/4". Regulator includes durable synthetic rubber diaphragm. Comes packaged as a convenient kit, with all the plumbing and hardware you'll need.



Looking for a Complete Dispensing System or Controls?
The Badger Advantage Continues on the Next Page...

Badger® Your One-Stop Solution for Reliable Concrete Admix Dispensing and Control

Complete Dispensing Systems

Whether you need a reliable dispensing system “ready-to-go” — or customized to your batching requirements, Badger has the fast, easy solution that’s just right for you. Our Direct Feed and Multi-Product systems are accurate, consistent, and easy to operate with either electric or air supply. They’ll interface with your control panel system or with semi-automatic controllers. Just call your knowledgeable Badger concrete representative or technical support team for a Badger-engineered solution for your Admix operation.

Innovation

Accuracy

Quality

Durability

Selection

Support



Dispenser Controls



AC-151
Single Unit Controller
NEMA 4X Rated



AC-154
Multi-Unit Controller



DP-10 Probe Amplifier
Interface Module

Call your Badger representative — or check out our web site — for details about Badger’s industry-trusted control units. Designed for automatic or manual operation, these precision units may be installed in stand-alone dispensing systems or may be seamlessly integrated into automated batching panels.

Probe Amplifier

Probe’s adjustable sensitivity assures accurate calibration. Available with a single, or, where redundancy is desired, a dual zero probe system. Plug in amplifier allows easier field service with less down time. Available with up to 4 units per board for faster, more efficient installation. NEMA 4X rated enclosure suitable for all environments.

Serving You Worldwide

Sales Facilities: USA ■ Germany ■ Mexico ■ Singapore

Concrete Products
6116 East 15th Street
P.O. Box 581390
Tulsa, OK 74112 U.S.A.
Tel: 918-836-8411
Fax: 918-832-9962

Corporate Headquarters
4545 West Brown Deer Road
P. O. Box 245036
Milwaukee, WI 53224-9536 U.S.A.
Tel: 414-355-0400
Fax: 414-355-7499



www.badgermeter.com

