

**GENERAL**

The Badger Meter RF - Fluid Management System is designed to control and monitor the consumption and inventory balances of automotive fluid products with minimal installation and programming costs. Badger has utilized its years of expertise in the Automated Meter Reading market to develop a control system utilizing RF communications between the keypad and the meter.

The wall mounted keypad module consists of a 12-button keypad, LCD display and integral ticket printer. The system can control up to 48 meters and track 8 different fluids and tanks. Sending and receiving data typically up to 300 feet in a service facility installation.

A unique, patented feature of the control system is that the trigger of the dispensing meter is locked until authorization from the keypad is received. After the dispense is completed, the user can top off the dispense and the actual amount used is sent back to the keypad and this meter returns to the locked status. Additionally, the meter can be installed on portable dolly systems offering control and monitoring of often-high cost lubrication products.

Up to 50 operators can be defined with their own unique PIN number for accessing the system. The system provides dispense reports by operator, fluid type, meter or tank. This allows for flexibility in reviewing system activity.

The operator enters his PIN number and selects the hose that the fluid is to be dispensed from. The operator then enters the required quantity and presses ENTER to confirm. Once a work order has been entered at the keypad, the operator simply pushes the RESET button on the meter to start communications between the meter and the keypad. The meter receives authorization from the keypad to unlock, along with the dispense batch quantity. When the trigger is pulled the pre-set dispense batch quantity dispenses.

The meter automatically shuts off when the dispense batch quantity has been reached.

A "Top Off" feature allows additional fluid to be dispensed and tracked after the batch quantity has been dispensed.

Upon completion of the dispense, the operator presses the RESET button. The meter then locks, prohibiting any unauthorized dispense of fluid to occur, and the dispense quantity is sent to the keypad.



After each dispense, a transaction ticket is printed showing the fluid and quantity dispensed along with the operator's name.

- Very low installation costs
- Patented "Lock-Out" to prevent unauthorized dispenses
- Oval Gear metering technology
- Measurement in Pints, Quarts, Gallons or Liters
- Field replaceable AA Batteries in meters
- Control of portable fluid tanks
- Integral ticket printer
- Serial port for report printer/remote ticket printer
- Remote antenna kit (optional)

- Fleet Maintenance Shops
- Industrial Assembly
- Quick Lube Facilities
- Automotive Dealerships
- Specialty Service and Repair Shops
- Construction and Mining Eq. Service Centers
- Additive dispensing

Power Requirements: 120 VAC 50/60 Hz

RF Communications: 2-way 902-928 MHz Frequency Hopping Spread Spectrum per FCC Part 15.247 Part 15.109

Operating Temperature: 14° F to +140° F (-10° C to +60° C)

Internal Printer Paper: White thermal paper roll 2¼" x 85'. You must have paper in the printer to dispense fluid.

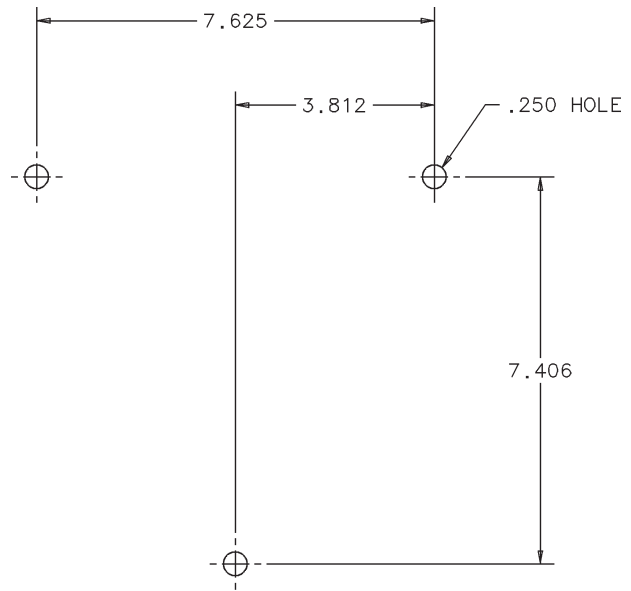

The keypad should be mounted upright with the antenna pointing upward, near a 120VAC electrical outlet, to a structurally sound wall through the two holes on the top of the keypad casing. Height on the wall should be 5' to 6'. Care should be taken to avoid mounting behind any steel objects (tool storage cabinets and metal chain linked fences) that may block the RF communication signal. Care should also be taken to avoid direct, significant heat sources.

### Pictorial Diagram of RF-OMS Logical Set-up

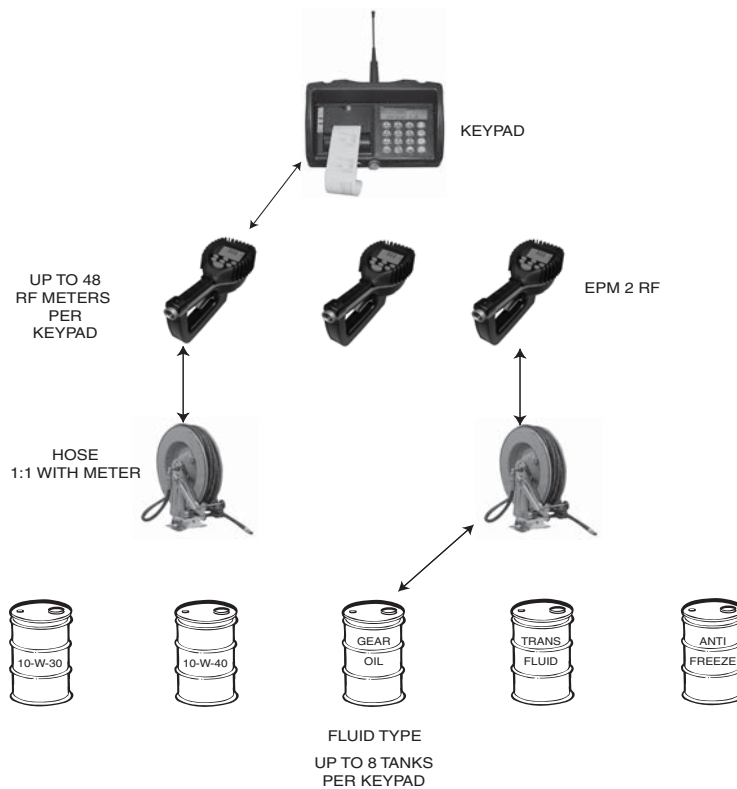

Please see our website at [www.badgermeter.com](http://www.badgermeter.com) for specific contacts.

Due to continuous research, product improvements and enhancements, Badger Meter reserves the right to change product or system specifications without notice, except to the extent an outstanding contractual obligation exists.



### BadgerMeter, Inc.

P.O. Box 245036, Milwaukee, WI 53224-9536  
 Telephone: (414) 355-0400 / (800) 456-5023  
 Fax: (414) 355-7499 / (866) 613-9305  
[www.badgermeter.com](http://www.badgermeter.com)