

Model MS-E1

Industrial Pulse Transmitter

Repair Parts

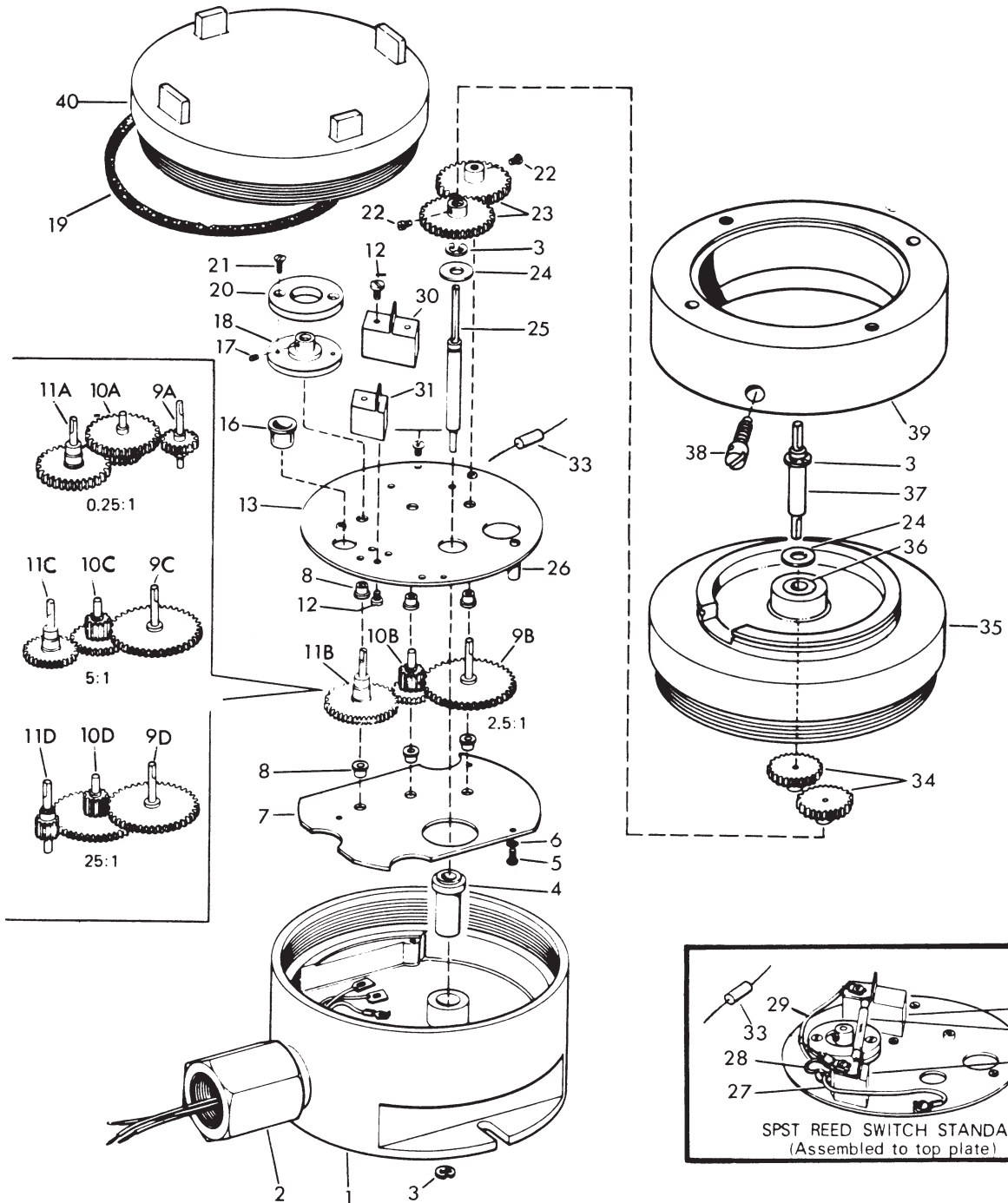

BadgerMeter, Inc.

IRP-047-12
Part No. 53401-047

ORDER INFORMATION: This repair parts bulletin shows an exploded view of the product with specific reference to those items available for replacement. The item number and part number may change at any time; therefore it is important when placing an order that a complete description of the part, meter size, model and serial number be provided.

ITEM	PART DESCRIPTION	PART NUMBER
1	Housing Bottom	26970-000
2	Adapter, Electrical	26990-000
3	E-Ring	22570-007
4	Bushing, Input Spindle	33289-000
5	Screw, Rd. Hd. #3-48 x 3/16	55109-084
6	Lockwasher	20454-000
7	Plate Assembly, Bottom	26991-000
8	Bushing, Spindle	26541-000
9	Gear & Spindle Assembly, First .25:1	26960-000
9	Gear & Spindle Assembly, First 2.5:1	26960-001
9	Gear & Spindle Assembly, First 5:1	26960-001
9	Gear & Spindle Assembly, First 25:1	26955-000
10	Gear & Pinion Assembly, Intermediate .25:1	26961-000
10	Gear & Pinion Assembly, Intermediate 2.5:1	26958-000
10	Gear & Pinion Assembly, Intermediate 5:1	26958-001
10	Gear & Pinion Assembly, Intermediate 25:1	26958-002
11	Gear & Spindle Assembly, Last .25:1	26959-000
11	Gear & Spindle Assembly, Last 2.5:1	26959-000
11	Gear & Spindle Assembly, Last 5:1	26959-001
11	Gear & Spindle Assembly, Last 25:1	26957-000
12	Screw, Thread Cutting #5-40 x 1/4	55161-141
13	Plate Assembly, Top, w/spacer post	26993-001
14	Screw, Rd. Hd. #5-40 x 3/16	55108-140
15	Lockwasher	22797-005
16	Bushing, Wire	30007-000
17	Screw, Hdls. Socket #4-40 x 1/8	55230-111
18	Magnet Carrier	26999-000
19	O-Ring	22650-030
20	Magnet, Pulse Transmitter	23018-001
21	Screw, Flat Hd. #2-56 x 1/4	55067-060
22	Setscrew, #4-48 x 1/8	1065-000
23	Gear, Drive	32486-000
24	Washer	22581-000
25	Spindle, Input	33290-000
26	Spacer Post	26995-000
27	Wire Assembly, Green	23218-021
28	Wire, Red	59274-001
29	Wire, Black	59274-002
30	Mounting Block, Reed Switch	26953-000
31	Mounting Block, Reed Switch	30483-000
32	Reed Switch	58639-001
33	Resistor	59004-002
34	Gear, Change (34 teeth, 0.761" O.D.)	23698-034
35	Cover, Register Adapter	26974-000
36	Bushing, Register Adapter Cover	33288-000
37	Spindle, Upper Drive	33287-000
38	Screw, Seal #12-24 x 7/8	19514-000
39	Ring, Register Adapter	26972-000
40	Cover, Plain (Standard)	30203-000

Note 1: When replacing the reed switch (item 32), the new switch may be physically a bit smaller than your old switch. For proper assembly, remove the mounting block (item 31) and reassemble it one hole closer to the other block on the plate assembly for proper fit.



Please see our website at
www.badgermeter.com
 for specific contacts.

Due to continuous research, product improvements and enhancements, Badger Meter reserves the right to change product or system specifications without notice, except to the extent an outstanding contractual obligation exists.



BadgerMeter, Inc.

P.O. Box 245036, Milwaukee, WI 53224-9536
 Telephone: (414) 355-0400 / (800) 456-5023
 Fax: (414) 355-7499 / (866) 613-9305
www.badgermeter.com